



# TRONSER TRIMMER

for  
professional  
electronics

DATUM / *DATE*: 26.04.2006  
ÄNDERUNG / *REVISION*: ---  
KUNDE / *CUSTOMER*: Daytonranger

## 60-1005-25010-902 LUFTRÖHRTRIMMER *AIRTUBULAR TRIMMER*

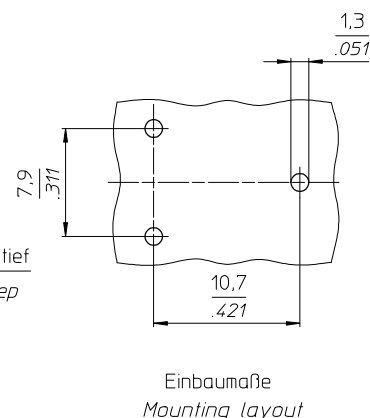
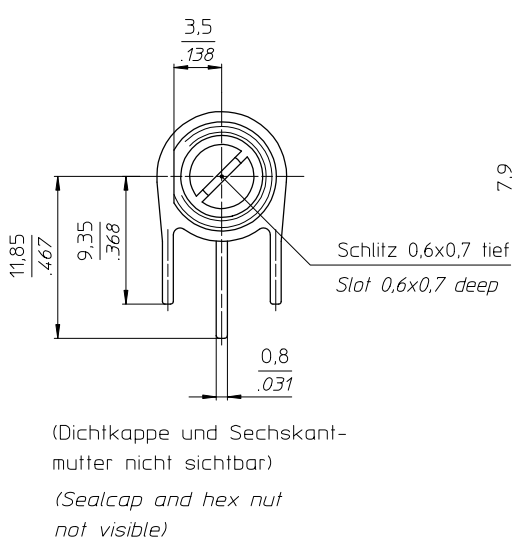
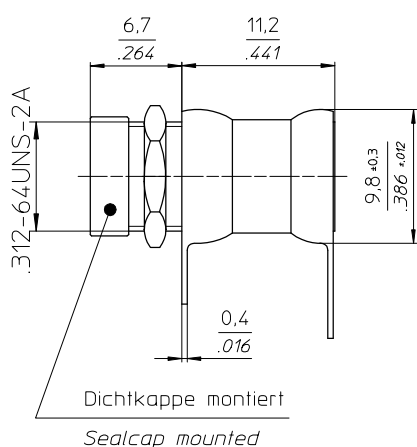

### TECHNISCHE MERKMALE UND DATEN / *TECHNICAL DATA*

|   |   |  |   |
|---|---|--|---|
| EINSTELLDREHMOMENT<br><i>TUNING TORQUE</i>        | 0,7 – 4,2 Ncm<br><i>0.9 - 5.8 in.oz.</i>  | LEBENSDAUER<br><i>ROTATIONAL LIFE</i>              | ≥ 75 Betätigungen, IEC 418<br><i>≥ 75 cycles, IEC 418</i> |
| ANSCHLAGDREHMOMENT<br><i>STOP TORQUE</i>          | max. 8,0 Ncm<br><i>max. 11.1 in.oz.</i>   | VIBRATION<br><i>VIBRATION</i>                      | 60 g / 10 - 2000 Hz<br><i>60 g / 10 - 2000 Hz</i>         |
| BEFESTIGUNGSDREHMOMENT<br><i>MOUNTING TORQUE</i>  | max. 75 Ncm<br><i>max. 104 in.oz.</i>   | STOSSBEANSPRUCHUNG<br><i>SHOCK</i>                 | 1500 g / 0,5 ms<br><i>1500 g / 0.5 ms</i>                 |
| EINSTELLGENAUIGKEIT<br><i>ADJUSTMENT ACCURACY</i> | ≤ 1 × 10 <sup>-3</sup> vom Einstellwert<br><i>≤ 1 × 10<sup>-3</sup> of adjusted value</i> | BETRIEBSTEMPERATUR<br><i>OPERATING TEMPERATURE</i> | -65°C ... +125°C<br><i>-65°C ... +125°C</i>               |
| KONTAKTWIDERSTAND<br><i>CONTACT RESISTANCE</i>    | < 0,001 Ω<br><i>&lt; 0.001 W</i>  | DIELEKTRIKUM<br><i>DIELECTRIC</i>                  | Luft<br><i>Air</i>  |

| Teile - Nr.<br><i>Part - No.</i> | C <sub>min</sub><br>[pF] | C <sub>max</sub><br>[pF] | Prüfspannung<br><i>Test Voltage</i><br>[VDC] | Q-Faktor<br><i>Q-Factor</i><br>[@ 200MHz] | R <sub>isol.</sub><br>R <sub>insul.</sub><br>[MΩ] | TK <sub>c</sub><br>[ppm / °C] | Maß A<br><i>Dim.A</i><br>[mm] | Maß B<br><i>Dim.B</i><br>[mm] | Gewicht<br><i>Weight</i><br>[ca. g] |
|----------------------------------|--------------------------|--------------------------|--|---|---|-------------------------------|-------------------------------|-------------------------------|-------------------------------------|
| 60-1005-25010-902                | 1,0                      | 10,0                     | 1000   | > 1000                                    | > 10 <sup>6</sup>                                 | 50 ± 15                       | ---                           | ---                           | 5,5                                 |

### SONDERANFERTIGUNG / *SPECIAL CONFIGURATION*

Befestigungsbuchse, Dichtkappe montiert, Statorlötfahne  
*Central mount bushing, seal cap mounted, stator solder tag*